

Operation, Parts, Repair

Contractor PC Spray Guns



3A6285M

EN



For the application of architectural paints and coatings. For professional use only.

3600 psi (24.8 MPa, 248 bar) Maximum Working Pressure See page 2 for additional model information.



Important Safety Instructions

Read all warnings and instructions in this manual. Refer to your sprayer instruction manual for Pressure Relief, priming and spray instructions. Save these instructions.

Important Medical Information



Read the medical alert card provided with the gun. It contains injection injury treatment information for a doctor. Keep it with you when operating the equipment.

Contractor PC Gun

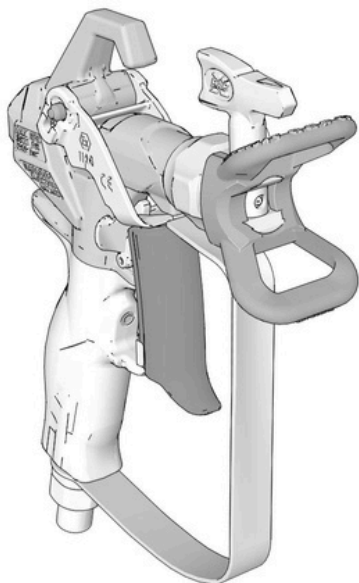

Contractor PC Compact Gun

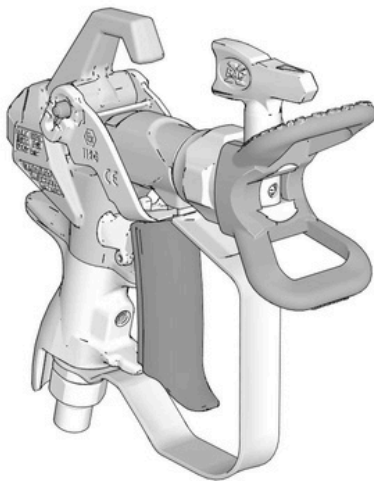

ti34244b



II 2 G Ex h IIA T6 Gb

PROVEN QUALITY. LEADING TECHNOLOGY.



Contents

Models	2
Warnings	3
Grounding	5
Setup	6
Pressure Relief Procedure	6
.....	6
Gun Trigger Lock	6
Trigger Adjustment (Contractor PC Gun only)	7
Install Tip and Tip Guard on Gun	8
Connect Gun to Sprayer	8
Operation	9
Aligning Spray	9
Spraying	9
Clear Spray Tip Clog	9
Cleanup	9
Parts	10
Tip and Guard	11
Maintenance	12
Cleaning/Replacing Filter	12
Repair/Replacement	13
Replacing Cartridge	13
Aligning Handle	14
Technical Specifications	15
California Proposition 65	15
Graco Standard Warranty	16
Graco Information	17











Models

Contractor PC Gun Models

Part No.	Tip(s)	Guard	Filter	Language Translation Included
17Y042	LTX517	RAC X	60 Mesh	English, French, Spanish
17Y043	L P5 17	RAC X	60 Mesh	English, French, Spanish, German
17Y044	L P5 17	RAC X	60 Mesh	English, Chinese, Japanese, Korean
17Y045	None	RAC X	60 Mesh	English, French, Spanish, German
17Y470	FFLP210	RAC X	100 Mesh	English, French, Spanish
82 62 52	LTX517 +	RAC X	60 Mesh	English, French, Spanish
17 Z6 44	L P5 17	RAC X	60 Mesh	English, French, Spanish
82 62 91	LTX515	RAC X	60 Mesh	English, French, Spanish
19Y349	L P5 17			
19Y350	LTX517	Contractor PC Compact Gun Models		
19Y443	L P5 17	RAC X	60 Mesh	English, French, Spanish
82 62 61	FFLP210	RAC X	60 Mesh	English, French, Spanish, German
		RAC X	100 Mesh	English, French, Spanish, German
	LTX517 +	RACX	60 Mesh	English, French, Spanish
	L P5 17			





Warnings

The following warnings are for the setup, use, grounding, maintenance, and repair of this equipment. The exclamation point symbol alerts you to a general warning and the hazard symbols refer to procedure-specific risks. When these symbols appear in the body of this manual or on warning labels, refer back to these Warnings. Product-specific hazard symbols and warnings not covered in this section may appear throughout the body of this manual where applicable.

 WARNING	
    	SKIN INJECTION HAZARD <p>High-pressure fluid from gun, hose leaks, or ruptured components will pierce skin. This may look like just a cut, but it is a serious injury that can result in amputation. Get immediate surgical treatment.</p> <ul style="list-style-type: none"> • Do not spray without tip guard and trigger guard installed. • Engage trigger lock when not spraying. • Do not point gun at anyone or at any part of the body. • Do not put your hand over the spray tip. • Do not stop or deflect leaks with your hand, body, glove, or rag. • Follow the Pressure Relief Procedure when you stop spraying and before cleaning, checking, or servicing equipment. • Tighten all fluid connections before operating the equipment. • Check hoses and couplings daily. Replace worn or damaged parts immediately.
   	FIRE AND EXPLOSION HAZARD <p>Flammable fumes, such as solvent and paint fumes, in work area can ignite or explode. Paint or solvent flowing through the equipment can cause static sparking. To help prevent fire and explosion:</p> <ul style="list-style-type: none"> • Use equipment only in well ventilated area. • Eliminate all ignition sources; such as pilot lights, cigarettes, portable electric lamps, and plastic drop cloths (potential static sparking). • Ground all equipment in the work area. See Grounding instructions. • Never spray or flush solvent at high pressure. • Keep work area free of debris, including solvent, rags and gasoline. • Do not plug or unplug power cords, or turn power or light switches on or off while flammable fumes are present. • Use only grounded hoses. • Hold gun firmly to side of grounded pail when triggering into pail. Do not use unless they are anti-static or conductive. • Stop operation immediately if static sparking occurs or you feel a shock. Do not use equipment until you identify and correct the problem. • Keep a working fire extinguisher in the work area.

Warnings

WARNING

 	<p>EQUIPMENT MISUSE HAZARD</p> <p>Misuse can cause death or serious injury.</p> <ul style="list-style-type: none"> • Always wear appropriate gloves, eye protection, and a respirator or mask when painting. • Do not operate or spray near children. Keep children away from equipment at all times. • Do not overreach or stand on an unstable support. Keep effective footing and balance at all times. • Stay alert and watch what you are doing. • Do not operate the unit when fatigued or under the influence of drugs or alcohol. • Do not kink or over-bend the hose. • Do not expose the hose to temperatures or to pressures in excess of those specified by Graco. • Do not use the hose as a strength member to pull or lift the equipment. • Do not spray with a hose shorter than 25 feet. • Do not alter or modify equipment. Alterations or modifications may void agency and create safety hazards. • Make sure all equipment is rated and approved for the environment in which you are using it.
	<p>PRESSURIZED ALUMINUM PARTS HAZARD</p> <p>Use of fluids that are incompatible with aluminum in pressurized equipment can cause serious chemical reaction and equipment rupture. Failure to follow this warning can result in death, serious injury, or property damage.</p> <ul style="list-style-type: none"> • Do not use 1,1,1-trichloroethane, methylene chloride, other halogenated hydrocarbons, or fluids containing such solvents. • Do not use chlorine bleach. • Many other fluids may contain chemicals that can react with aluminum. Contact your material supplier for compatibility.
	<p>PERSONAL PROTECTIVE EQUIPMENT</p> <p>Wear appropriate protective equipment when in the work area to help prevent serious injury, including eye injury, hearing loss, inhalation of toxic fumes, and burns. This protective equipment includes but is not limited to:</p> <ul style="list-style-type: none"> • Protective eyewear, and hearing protection. • Respirators, protective clothing, and gloves as recommended by the fluid and equipment manufacturer.

Grounding

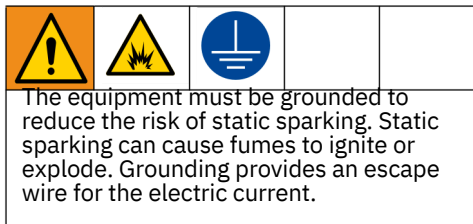

Spray Gun: ground through connection to a properly grounded fluid hose and pump.
Fluid Supply Container: follow local code.
Solvent Pails Used when Flushing: follow local code. Use only conductive metal pails, placed on a grounded surface. Do not place the pail on a nonconductive surface, such as paper or cardboard, which interrupts grounding continuity.

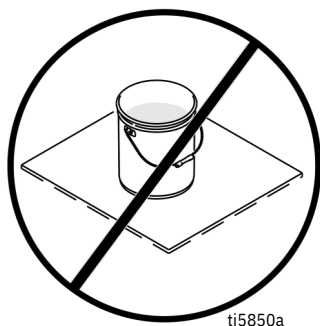

Fluid Hose: use only electrically conductive hoses with a maximum of 500 ft. (150 m) combined hose length to ensure grounding continuity. Check electrical resistances of hoses. If total resistance to ground exceeds 29 megohms, replace hose immediately.

Ground Metal Pails: Connect a ground wire to the pail by clamping one end to the pail and the other end to a ground such as a water pipe.

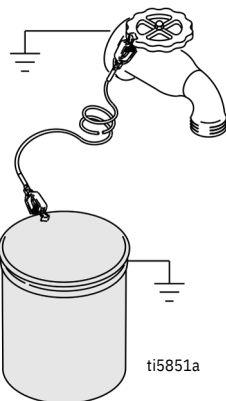

Maintain Grounding Continuity: When flushing or relieving pressure, hold a metal part of the gun firmly against the side of a grounded metal pail, then trigger the gun.

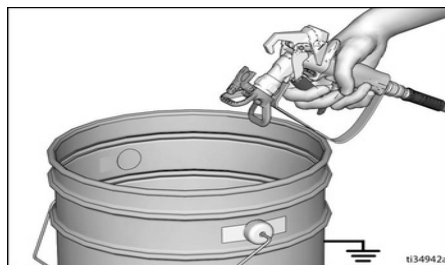

Setup

Setup

Pressure Relief Procedure



Follow the Pressure Relief Procedure whenever you see this symbol.

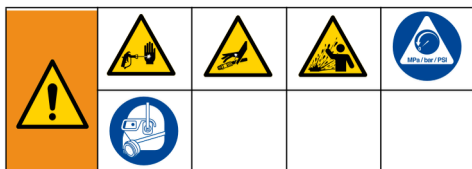

This equipment stays pressurized until pressure is manually relieved. To help prevent serious injury from pressurized fluid, such as skin injection or splashed fluid, follow the Pressure Relief Procedure whenever sprayer is stopped and before sprayer is cleaned or checked, and before equipment is serviced.

1. Turn sprayer OFF.
2. Engage the trigger lock. Always engage the trigger lock when sprayer is stopped to prevent the gun from being triggered accidentally.
3. Turn pressure control knob to lowest setting.
4. Put drain tube into a waste pail and turn Prime/Spray valve in PRIME position (drain) to relieve pressure. Hold the
5. gun firmly to a pail. Point gun into pail. Disengage the trigger lock and trigger the gun to relieve pressure.

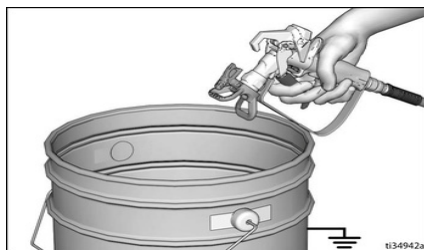

6. Engage the trigger lock.

7. If you suspect the spray tip or hose is clogged or that pressure has not been fully relieved:
 - a. VERY SLOWLY loosen the tip guard retaining nut or the hose end coupling to relieve pressure gradually.
 - b. Loosen the nut or coupling completely.
 - c. Clear airless hose or spray tip obstruction. See Clear Spray Tip Clog, page 9.

Gun Trigger Lock



To prevent injury when the gun is not in use, always engage the gun's trigger lock if unit is being shut down or left unattended.



Trigger Adjustment (Contractor PC Gun only)

The trigger can be adjusted to different lengths depending upon user preference.

1. Relieve pressure. See Pressure Relief Procedure, page 6.
2. Loosen adjustment knob (13c). Use a flat blade screwdriver or coin if the knob (13c) cannot be loosened by hand. Complete one full turn to loosen the adjustment knob. Three full turns could result in the adjustment knob falling out.
3. Hold end of trigger (13b) and slide to desired position.

NOTE: Hold trigger in location shown when adjusting.

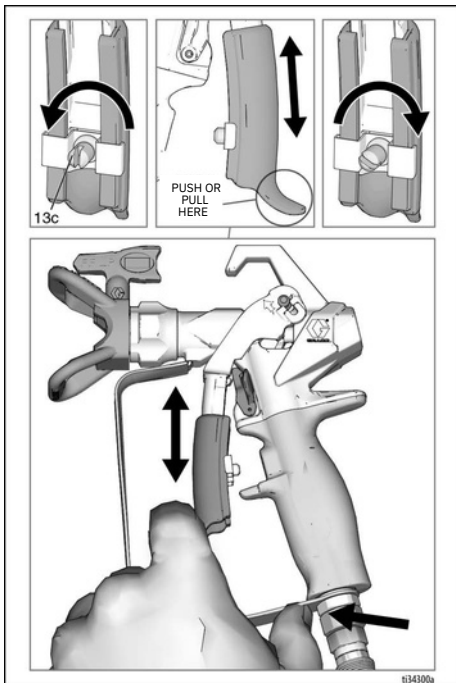

4. Tighten adjustment knob (13c) firmly.

NOTE: If trigger is too difficult to slide, use a flat blade screwdriver to slide it down and apply grease to the location shown.

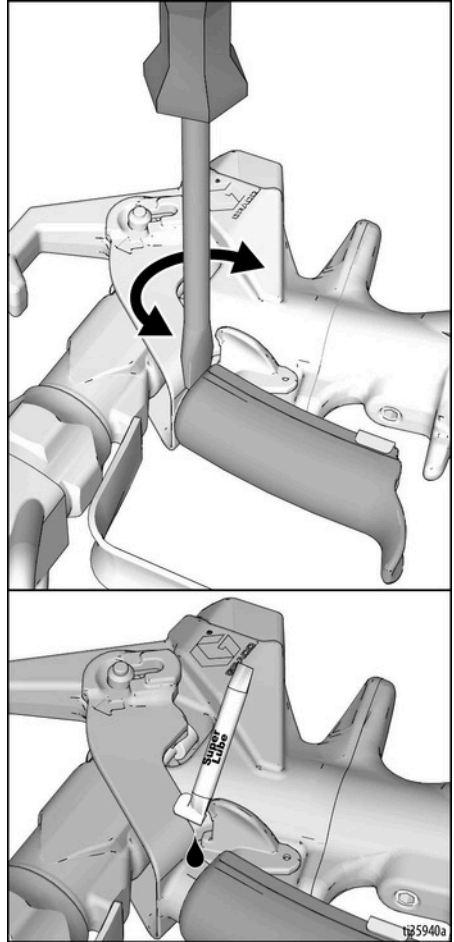

Setup

Install Tip and Tip Guard on Gun



NO

YES

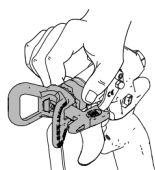

To prevent spray tip leaks make certain spray tip and tip guard are installed properly.

1. Relieve pressure. See Pressure Relief Procedure, page 6. Engage trigger lock (15).
2. Use spray tip (26) to align gasket and seal (24) in the tip guard (25).

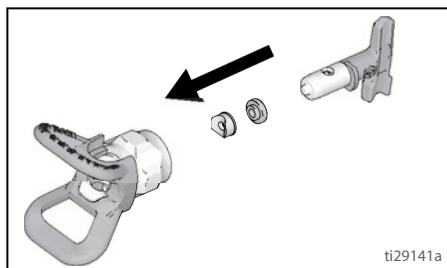

3. Insert tip (26) in guard (25).

4. Verify spray tip and tip guard parts are assembled in the order shown.

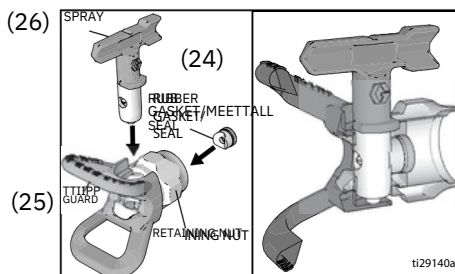

5. Install guard (25) over end of gun (1). Hand tighten retaining nut.

Connect Gun to Sprayer

Make sure sprayer is turned off and unplugged from power source. Refer to your sprayer instruction manual for priming and spray instructions.

1. Attach supply hose to sprayer fluid outlet.
2. Attach other end of supply hose to gun swivel (7). Use two wrenches (one on the swivel (7) and one on the hose), to tighten all connections securely.
3. Refer to sprayer instruction manual for priming instructions.

Operation



Aligning Spray

1. Relieve pressure. See Pressure Relief Procedure, page 6. Engage trigger lock (15).
2. Loosen guard (25) retaining nut.
3. Align guard (25) horizontally to spray a horizontal pattern or vertically to spray a vertical pattern.

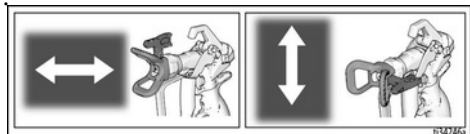

4. Hand tighten guard (25) retaining nut when you have adjusted to desired setting.

Spraying

1. Disengage trigger lock (15).
2. Be sure the arrow shaped tip (26) faces forward (spray).
3. Hold gun perpendicular and approximately 12 inches (304 mm) from surface. Move gun first, then pull gun trigger (13) to spray a test pattern.
4. Slowly increase pump pressure until coverage is uniform and even (see sprayer instruction manual for additional information).

Clear Spray Tip Clog

In the event that particles or debris clog the spray tip, this gun is designed with a reversible spray tip that quickly and easily clears the particles without disassembling the sprayer.

1. Engage trigger lock (15). Rotate spray tip (26) to unclog position. Disengage trigger lock (15). Trigger gun at waste area to clear clog.

NOTE: If spray tip (26) is difficult to rotate when turning to the unclog position, perform Pressure Relief Procedure, page 6, then turn Prime/Spray valve to spray position and repeat step 1.

2. Engage trigger lock (15). Rotate spray tip (26) back to spray position. Disengage trigger lock (15) and continue spraying.

Cleanup

Flush gun, clean filter (see Cleaning/Replacing Filter on page 12) and clean paint off the outside after each work shift. Store in a dry location. Refer to your sprayer manual for flushing instructions. Do not leave the gun or any parts in water or cleaning solvents.

NOTICE

To prevent damage to the gun parts, do not leave the gun or any parts, except the tip, in water or cleaning solvents. The gun is NOT compatible with cleaning solvents that contain methylene chloride.

Parts

Contractor PC Compact

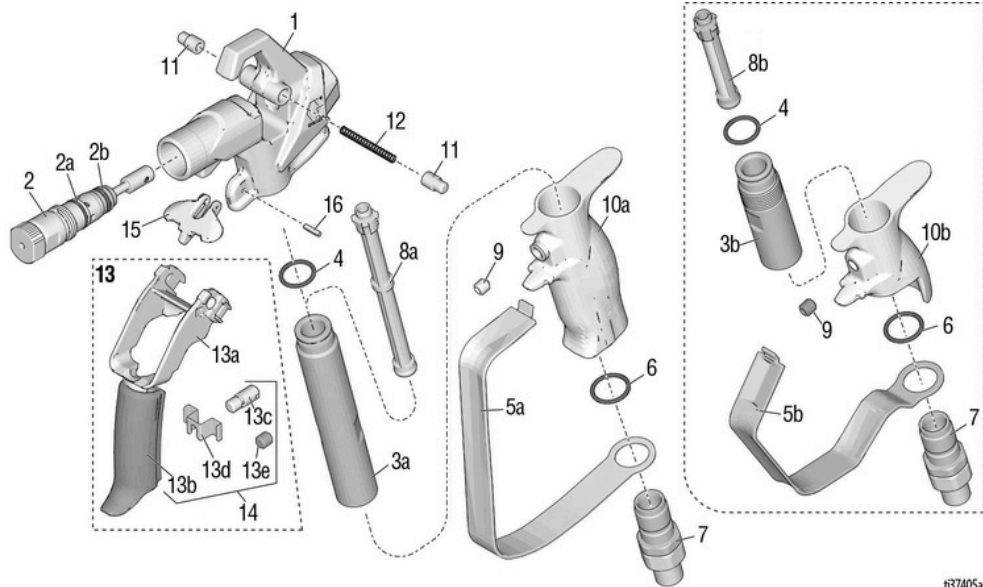

Ref. Part	Description	Qty	Ref. Part	Description	Qty
1	17X49 HOUSING, assy	1	11	17Z28 PIN, trigger SPRING,	2
2	6 Includes 15, 16		8	compression TRIGGER,	1
2a	17Y29 KIT, repair, cartridge, includes	1	17V76 Contractor PC,		1
2b	7 2a, 2b		6	assy includes 11, 12, 13a,	
3a	17W752PACKING, o-ring	1	17Y46 13b, 13c, 13d TRIGGER,		
3b	PACCKING, o-ring	1	19Y440 Compact, assy		1
4	10B7 handle, Contractor PC	1		includes 11, 12, 13a, 13b, 13e	
5a	10B7 handle, Compact	1	13a	TRIGGER, upper	1
5b	PACKING, o-ring	1	13b	TRIGGER, lower	1
6	6VA305 trigger, Contractor	1	13c	KNOB, adjustment	1
7	19Y270 120733	1	13d	CLIP, trigger	1
8a	28BRL trigger, Compact	1	13e	SCREW, set	1
	28RD3C, urethane seal	1	14	17Z690 TRIGGER, Contractor PC,	1
	19M356, assy, 19M356	1	19Y512 repair includes 13b, 13c, 13d		
	FILTER gun, Contractor PC	1	17V767 TRIGGER, Compact, repair		1
	10Y226 SCREW, set		17Y024 includes 13b, 13e		
	100 mesh		15	119799 LOCK, trigger	1
	60 and 100 mesh combo		16▲	222385 PIN, spring	1
8b	FILTER, gun, Compact	1	20	BRUSH, cleaning (not shown)	1
	60 mesh			CARD, medical alert (not s how n)	1
	100 mesh				
	60 and 100 mesh combo				
9		1	▲ Replacement safety labels, tags and cards are available at no cost.		
10a	17T030 HANDLE, gun, Contractor PC	1			
10b	19Y376 HANDLE, gun, Compact	1			

▲ Replacement safety labels, tags and cards are available at no cost.

Tip and Guard

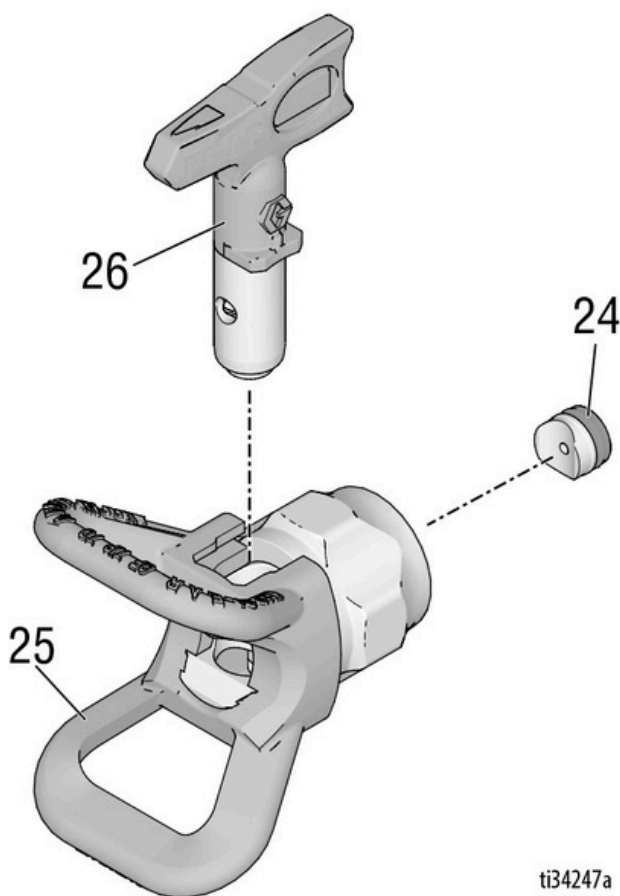

ti34247a

Ref. Par t	Description	Qty
24 24 64	OneSeal™, RAC X (5-pack)	1
53 24	KIT, SOLVENT, RAC X	1
89 36	OneSeal™, FFLP, LP	1
17 P5	(5-pack)	1
01	KIT, SOLVENT, FFLP, LP	1
25 17 P5	GUARD, RAC X	1
26†	TIP, spray	1
02	TIP, spray 517, RAC X	1
24 62	Models: 17Y042, 826252,	
15	19Y349, 826261	
LT517	TIP, spray 515, RAC X	1
5 LP 51	Model: 17Z644	
	TIP, spray 517, LP	1

Ref. Par t	Description	Qty
	Models: 17Y043, 17Y044, 826252, 19Y350, 826261, 826291	
FFLP210	TIP, spray, 210 FFLP	1
	Models: 17Y470, 19Y443	

† For a list of all available tip sizes, talk to your local distributor or visit www.graco.com.

Maintenance



To avoid serious injury from skin injection, follow the Pressure Relief Procedure before performing any maintenance on the gun.

Cleaning/Replacing Filter

A plugged filter reduces gun performance. Clean filter after each use.

1. 2. 3. Relieve pressure. See Pressure Relief Procedure, page 6.
- Disconnect fluid hose from gun at swivel (7).
- Disconnect trigger guard (5) from housing (1) as shown.

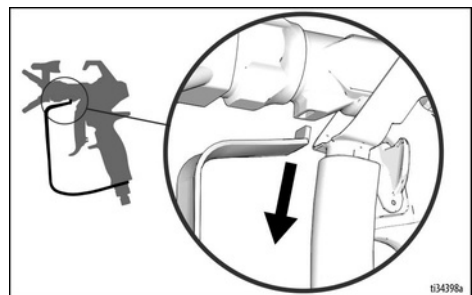

- 4 Engage trigger lock (15).
- Contractor PC: Unscrew handle (10) from housing (1).

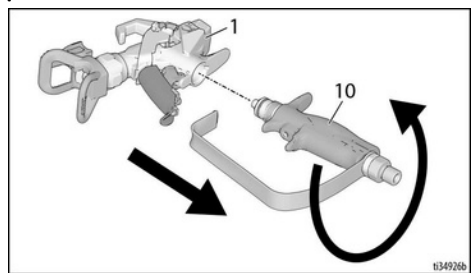

Contractor PC Compact: Unscrew handle (10) from housing (1) using guard (5).

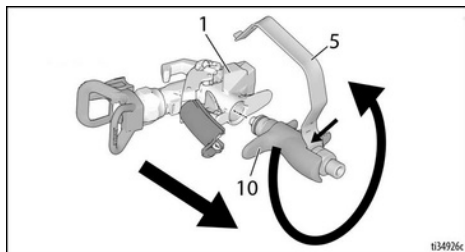

- 6 Remove filter (8) through top of handle (10).
- 7 Clean filter (8). Use a soft brush to loosen and remove excess debris.
- 8 Inspect filter (8) for damage to the filter mesh. Replace the filter if the filter mesh has holes or voids.
9. Inspect handle tube (3) for damage. Replace if it is corroded or pitted and check material for compatibility with aluminum.
10. Inspect o-ring (4) and replace if necessary.
11. Insert clean filter (8) into handle (10).
12. Reattach handle (10) to housing (1). Tighten securely.
13. Disengage trigger lock (15).
14. Reconnect trigger guard (5) into the slot in the housing (1) as shown.

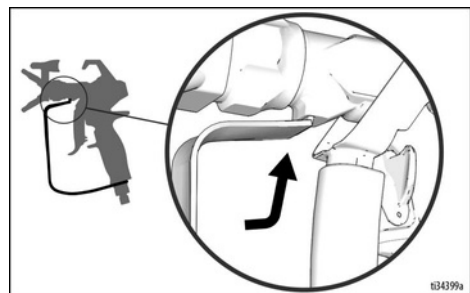

15. Engage trigger lock.

Repair/Replacement



- Unscrew cartridge (2) from front of gun (1).

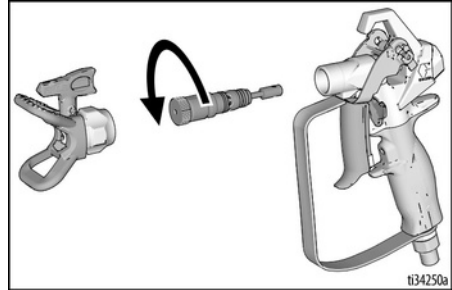

NOTE: If it is too difficult to remove by hand, use a 1/8" allen wrench or 5/8 wrench (if your cartridge has flats) to break loose as shown.

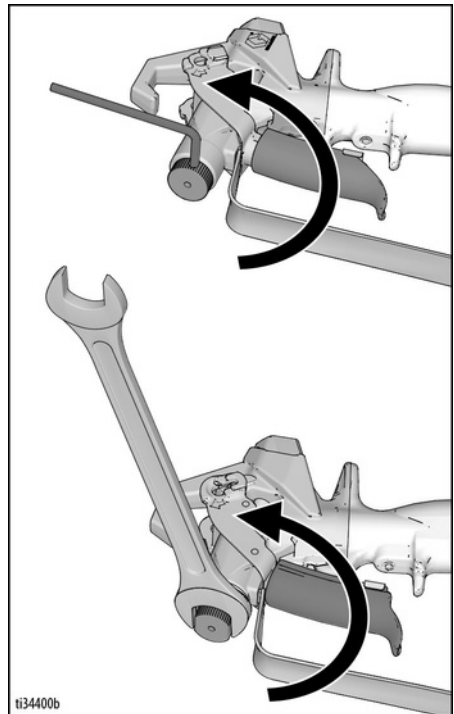

- Use a soft brush to clean out internal passages of gun.

Replacing Cartridge

Replace cartridge if the assembly is leaking or if there is a loss in spray performance that cannot be resolved by flushing the gun.

- Relieve pressure. See Pressure Relief Procedure, page 6.
- Engage trigger lock (15).
- Remove tip (26) and guard (25) from gun (1).
- Disengage trigger lock (15).
- Depress 2 pins (11) and pull trigger assembly (13) up into repair position as shown.

NOTICE

Never attempt to remove the cartridge unless the trigger assembly (13) is in the repair position --- cartridge will not come out. If cartridge is left partially removed, the gun will not operate properly.

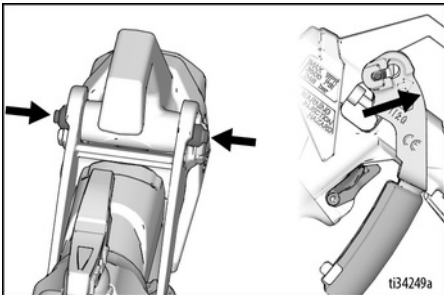

Repair/Replacement

8. Install new cartridge (2) into the gun and torque to 150 in-lbs (17.0 N-m). There should be no gap in the indicated area below (a).

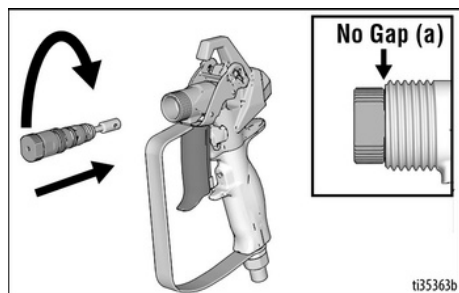

9. Push trigger assembly (13) back down into spray position. The push pins (11) should snap back out to normal position when trigger assembly (13) is fully engaged. Verify the cartridge is installed correctly by making sure the trigger assembly (13) can wiggle back and forth.

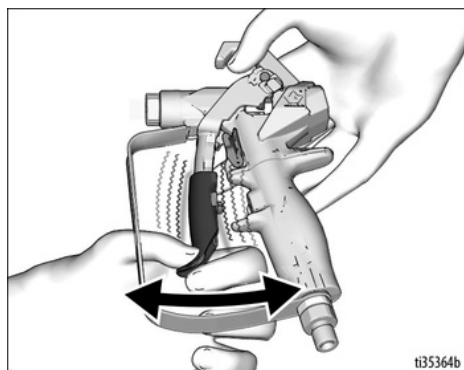

NOTE: Do not operate the gun if the cartridge is not installed correctly.
10. Reinstall tip (26) and guard (25).

Aligning Handle

If when tightened securely, handle no longer matches up with housing, realign handle.

1. Relieve pressure. See Pressure Relief Procedure, page 6. Engage trigger lock (15).
2. Tighten handle (10) securely.
3. Loosen set screw (9) using a 1/8" allen wrench.
4. Rotate handle (10) so it is aligned with housing (1).
5. Tighten set screw (9) securely.

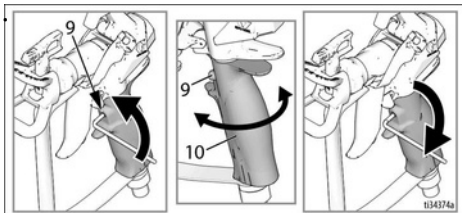

Technical Specifications

Maximum working pressure

Fluid orifice size	3600 psi (248 bar, 24.8 MPa)	
Inlet	0.120 in. (3.05 mm)	
Maximum material temperature	1/4 NPSM swivel	
Wetted Parts	120° F (49° C)	
Weight	Stainless steel, aluminum, tungsten carbide, solvent resistant elastomer, UHMwpE, acetal	
Gun		
Contractor		
Contractor PC - A	Without Tip and Guard	With Tip and Guard
Contractor PC - B	21.2 oz (601 g)	23.8 oz (675 g)
Contractor PC Compact	17.4 oz (493 g)	20.0 oz (567 g)
Noise Level*	18.8 oz (533 g)	21.4 oz (607 g)
Sound power	16.1 oz (456 g)	18.7 oz (530 g)
Sound pressure		
	87 dBa	
	78 dBa	
* Measured at 3.1 feet (1m) while spraying water-based paint, specific gravity 1.36, through a 517 tip at 3000 psi (207 bar, 20.7 MPa) per ISO 3744.		

California Proposition 65

CALIFORNIA RESIDENTS

 WARNING: Cancer and reproductive harm –
www.P65warnings.ca.gov.

Translated Manuals

3A 62	Spanish	3A 63	Latvian
89 3A	French	03 3A	Lithuanian
62 90	Dutch	63 04	Poli sh Hu
3A 62	Italian	3A 63	ngari an
91 3A	Turkish	05 3A	Czech Slov
62 92	Greek	63 06	a ki an
3A 62	Croatian	3A 63	Slovenian
93 3A	Portuguese	07 3A	Romanian
62 94	Danish	63 08	Bulgarian
3A 62	Finnish	3A 63	Chinese
95 3A	Swedish	09 3A	Japanese
62 96	Norwegian	63 10	Korean
3A 62	Russian	3A 63	German
97 3A	Estonian	11 3A	Hindi
62 98		63 12	Indonesian
3A 62		3A 63	
63 00		63 14	
3A 63		3A 63	
3A 63		18 3A	
63 02		74 98	
		21 71	

Translated manuals can be requested through a distributor or at www.graco.com.

Graco Standard Warranty

Graco Standard Warranty

Graco warrants all equipment referenced in this document which is manufactured by Graco and bearing its name to be free from defects in material and workmanship on the date of sale to the original purchaser for use. With the exception of any special, extended, or limited warranty published by Graco, Graco will, for a period of twelve months from the date of sale, repair or replace any part of the equipment determined by Graco to be defective. This warranty applies only when the equipment is installed, operated and maintained in accordance with Graco's written recommendations.

This warranty does not cover, and Graco shall not be liable for general wear and tear, or any malfunction, damage or wear caused by faulty installation, misapplication, abrasion, corrosion, inadequate or improper maintenance, negligence, accident, tampering, or substitution of non-Graco component parts. Nor shall Graco be liable for malfunction, damage or wear caused by the incompatibility of Graco equipment with structures, accessories, equipment or materials not supplied by Graco, or the improper design, manufacture, installation, operation or maintenance of structures, accessories, equipment or materials not supplied by Graco.

This warranty is conditioned upon the prepaid return of the equipment claimed to be defective to an authorized Graco distributor for verification of the claimed defect. If the claimed defect is verified, Graco will repair or replace free of charge any defective parts. The equipment will be returned to the original purchaser transportation prepaid. If inspection of the equipment does not disclose any defect in material or workmanship, repairs will be made at a reasonable charge, which charges may include the costs of parts, labor, and transportation.

THIS WARRANTY IS EXCLUSIVE, AND IS IN LIEU OF ANY OTHER WARRANTIES, EXPRESS OR IMPLIED, INCLUDING BUT NOT LIMITED TO WARRANTY OF MERCHANTABILITY OR WARRANTY OF FITNESS FOR A PARTICULAR PURPOSE.

Graco's sole obligation and buyer's sole remedy for any breach of warranty shall be as set forth above. The buyer agrees that no other remedy (including, but not limited to, incidental or consequential damages for lost profits, lost sales, injury to person or property, or any other incidental or consequential loss) shall be available. Any action for breach of warranty must be brought within two (2) years of the date of sale.

GRACO MAKES NO WARRANTY, AND DISCLAIMS ALL IMPLIED WARRANTIES OF MERCHANTABILITY AND FITNESS FOR A PARTICULAR PURPOSE, IN CONNECTION WITH ACCESSORIES, EQUIPMENT, MATERIALS OR COMPONENTS SOLD BUT NOT MANUFACTURED

BY GRACO. These items sold, but not manufactured by Graco (such as electric motors, switches, hose, etc.), are subject to the warranty, if any, of their manufacturer. Graco will provide purchaser with reasonable assistance in making any claim for breach of these warranties.

In no event will Graco be liable for indirect, incidental, special or consequential damages resulting from Graco supplying equipment hereunder, or the furnishing, performance, or use of any products or other goods sold hereto, whether due to a breach of contract, breach of warranty, the negligence of Graco, or otherwise.

FOR GRACO CANADA CUSTOMERS

The Parties acknowledge that they have required that the present document, as well as all documents, notices and legal proceedings entered into, given or instituted pursuant hereto or relating directly or indirectly hereto, be drawn up in English. Les parties reconnaissent avoir convenu que la rédaction du présent document sera en Anglais, ainsi que tous documents, avis et procédures judiciaires exécutés, donnés ou intentés, à la suite de ou en rapport, directement ou indirectement, avec les procédures concernées.

Graco Information

For the latest information about Graco products, visit www.graco.com.

For patent information, see www.graco.com/patents.

TO PLACE AN ORDER, contact your Graco distributor or call 1-800-690-2894 to identify the nearest distributor.

All written and visual data contained in this document reflects the latest product information available at the time of publication.

Graco reserves the right to make changes at any time without notice.

Original instructions. This manual contains English. MM 3A6285

Graco Headquarters: Minneapolis

International Offices: Belgium, China, Japan, Korea

GRACO INC. AND SUBSIDIARIES • P.O. BOX 1441 • MINNEAPOLIS MN 55440-1441 • USA

Copyright 2018, Graco Inc. All Graco manufacturing locations are registered to ISO 9001.
www.graco.com

Revision M, September 2024